

NOTES:

- ① JUNCTION BOXES: J1--NORMAL POWER, J2--EMERGENCY POWER, J3--NURSE CALL, J4--TELEPHONE.
- ② GAS PIPING: TYPE L COPPERTUBING. OXYGEN AND AIR--1/2" I.D., VACUUM--3/4" I.D.
- ③ PANEL LAMINATE COLOR: TO BE DETERMINED.

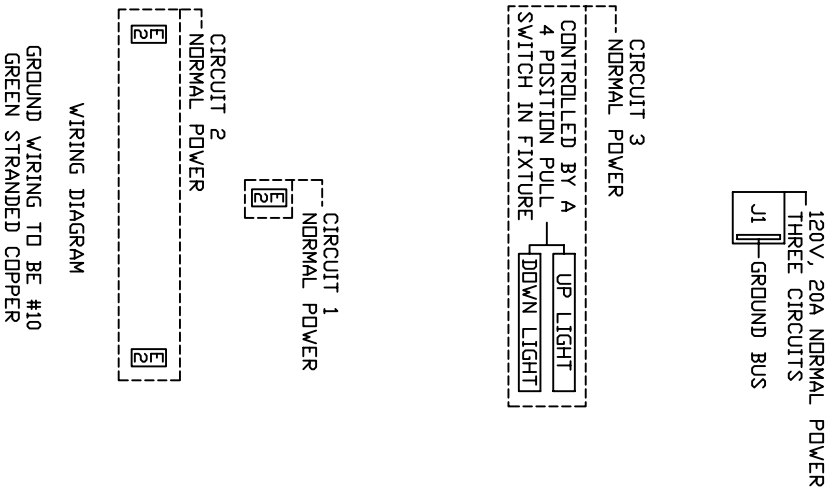

WIRING DIAGRAM
GROUND WIRING TO BE #10
GREEN STRANDED COPPER

<p>MODULAR SERVICES COMPANY 109 N. E. 38TH STREET OKLAHOMA CITY, OK. 73105</p>	<p>PROJECT</p>	<p>REVISED</p>	<p>THREE-QUARTER LENGTH GENERAL CARE MODULAR HEADWALL MODEL 1102</p>
	<p>SCALE: 1" = 1'</p>	<p>DATE: 03/21/05</p>	<p>DRAWN BY: DRAWING # PB-148</p>

SERVICES TO BE REVERSED
ON OPPOSITE HAND UNITS

LOW ACUITY
-- REQ'D. -- AS SHOWN
-- OPPOSITE

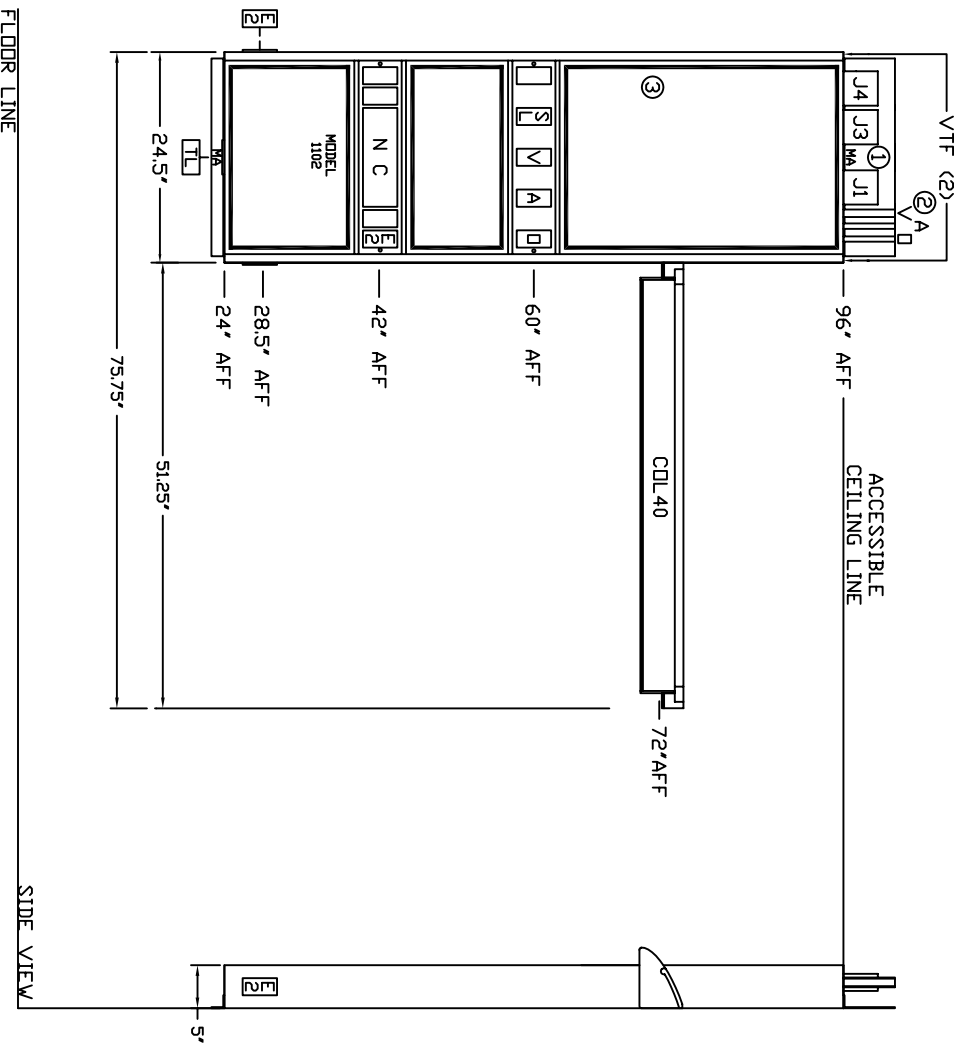

*AFF: ABOVE FINISHED FLOOR

