

NOTES:

- ① JUNCTION BOXES: J1--NORMAL POWER, J2--EMERGENCY POWER, J3--NURSE CALL/CODE BLUE, J4--TELEPHONE.
- ② GAS PIPING: TYPE L COPPERTUBING. OXYGEN AND AIR--1/2" I.D., VACUUM--3/4" I.D.
- ③ PANEL LAMINATE COLOR: TO BE DETERMINED.
- ④ CONDUIT: C1--MONITOR (1-1/4")

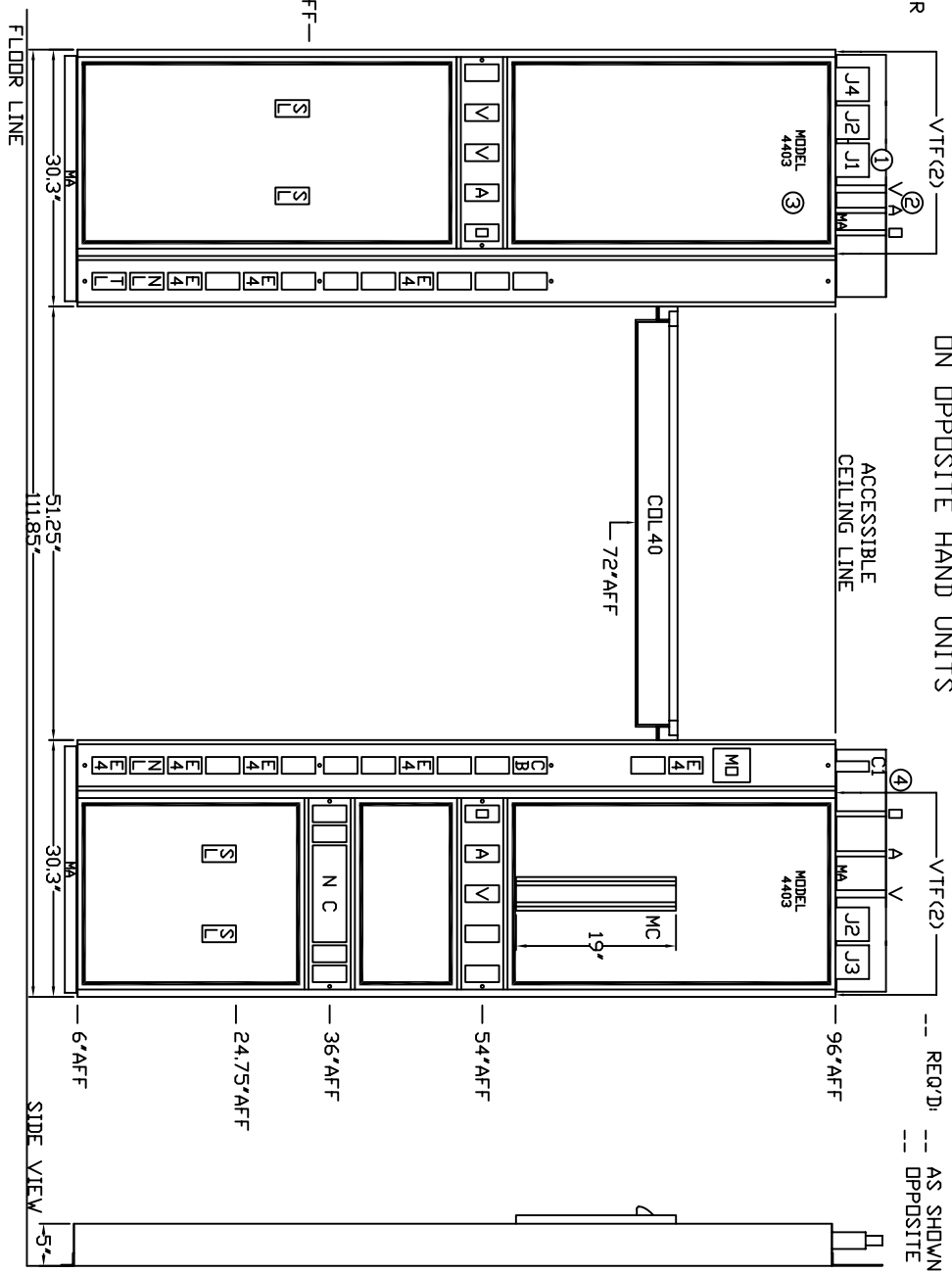
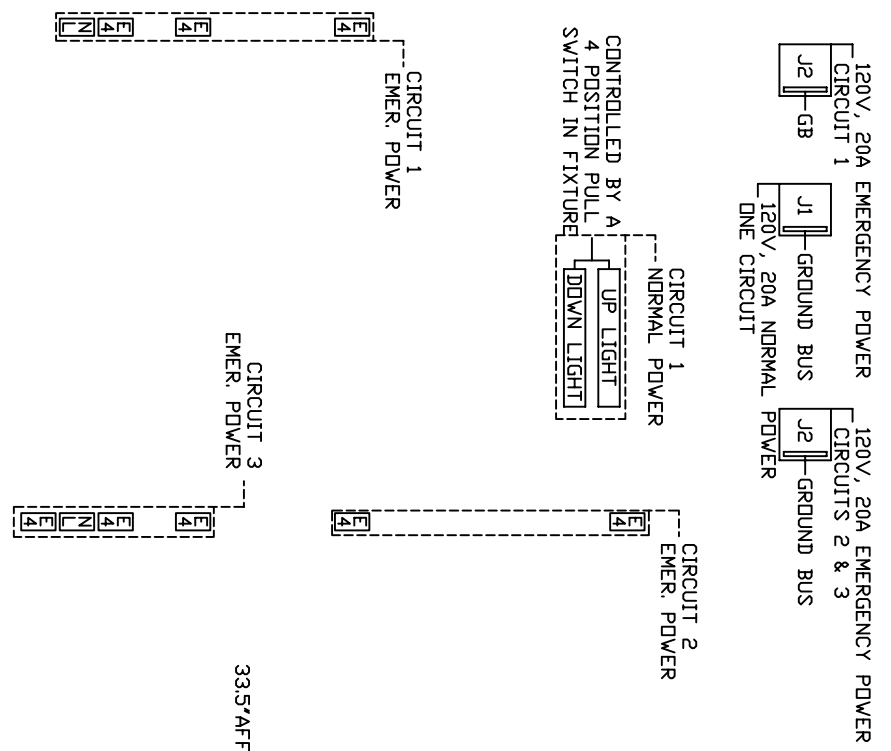

MODULAR 109 N. E. 38TH STREET
SERVICES COMPANY OKLAHOMA CITY, OK 73105

PROJECT

REVISED

FULL LENGTH

TWO MODULE SPECIAL
CARE MODULAR HEADWALL
MODEL 4403

SCALE: 1" = 1'

DATE: 03/21/05

DRAWN BY: DRAWING #

PB-158

SERVICES TO BE REVERSED
ON OPPOSITE HAND UNITS

*AFF: ABOVE FINISHED FLOOR

